



**Series GBV350B + AT00 D**  
**3-pc Body High Pressure Ball Valve**  
**Direct Mounting Type 2000PSI**  
**With Double Acting Actuator**



**SPECIFICATION**

- Three-Piece-Body API607 Fire safe
- ISO 5211 DIN3337 direct mounting pad
- End Connection: Threaded End BSPT  
Options for Socket Weld, Butt Weld
- Working Pressure: 1/4 ~ 2" 2000 PSI W.O.G.  
2-1/2" ~ 4" 1000 PSI W.O.G.

**APPLICATIONS**

- Suitable for Water, Oil, Gas, Air & Steam
- Working temperature up to 180° C

**PNEUMATIC ACTUATOR**

- High performance Rack & Pinion design
- Aesthetically compact and modern design
- 17 different model sizes from P32 to P350
- Standard working temperature -20 to +80 °C
- Adjustable closing angle -5 °C to +5 °C
- ISO 5211 and NAMUR mounting standards
- Recommended Air supply 6 bar, lubrication not required

**PNEUMATIC ACTUATOR MATERIAL**

Body : Anodized aluminum ASTM6063, UNI4522  
 End Caps : Die-cast aluminum, epoxy coated  
 Pistons : Die-cast aluminum UNI 5076  
 Pinion : Carbon steel, options for stainless steel  
 Bearing Pad : Technopolymer  
 Seals : NBR, options for Viton or Silicon

**BALL VALVE MATERIAL LIST**

NO.	PART NAME	MATERIAL
1	Body	CF8
2	Seat	R-PTFE
3	Ball	SS316
4	Gasket	R-PTFE
5	Bolt	SS304
6	Bonnet	CF8
7	Stem	SS304
8	Stem Washer	R-PTFE
9	Packing	R-PTFE
10	Gland	SS304
11	Snap Ring	SS304
12	Stopper	SS304
13	Bolt	SS304
14	Nut	SS304
15	Spring Washer	SS304

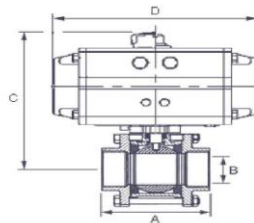

**DIMENSIONS (mm)**

Valve Size	Inch	1/4	3/8	1/2	3/4	1	1-1/4	1-1/2	2	2-1/2	3	4
	DN	8	10	15	20	25	32	40	50	65	80	100
Valve Torque (Nm)		24	24	24	44	85	100	163	238			
Double Acting Actuator	Art No.	AT-40D				AT-50D	AT-63D		AT-75D	AT-88D		AT-100D
	A	63	63	63	73	85	95	114	134	180	200	228
	B	11.6	12.7	15.0	20.0	25.0	32.0	38.0	50.0	65.0	80.0	100.0
	C	134	134	134	138	168	189	205	230	286	295	339
	D	116	116	116	116	146	163	163	214	252	252	270

