

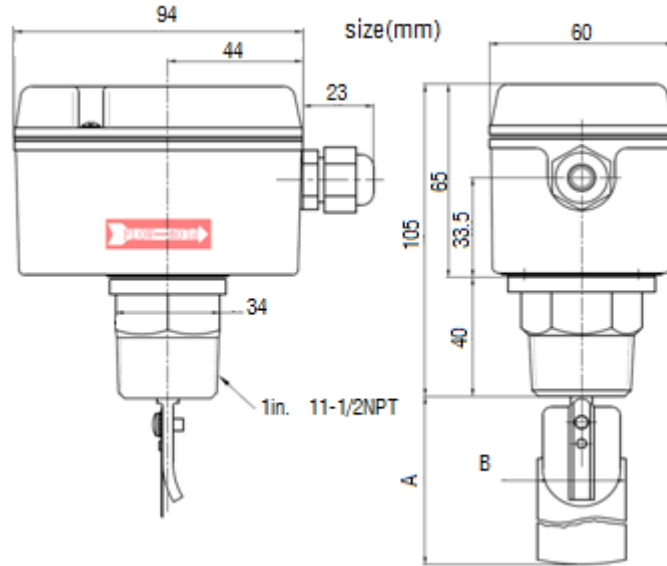

HLS series Flow Switch instruction letter

Introduction: HLS Series liquid flow switches for liquid flowing through the pipeline flow changes, such as water, ethylene glycol or other non-hazardous liquids; When the liquid flow over or single-pole double-throw switch contact (SPDT) make a loop turn-on, while cutting off other a loop, the flow switch is commonly used or "stop" protection sites.



According to the pipeline specifications

	in. (mm)	
	A	B
1 (25)	1-7/16 (37)	1 (25)
2 (51)	2-1/2 (64)	1-1/8 (29)
3 (76)	3-1/2 (89)	1-1/8 (29)
4 (101)	6-5/8 (168)	1-1/8 (29)
5 (152)	6-5/8 (168)	1-1/8 (29)

Characteristic:

- Liquid pressure up to 1MPa, the use of a wide range;
- Stainless steel blades are 3 section, for the diameter of 25 - 75 mm the pipeline;
- According to require to moved out the number of blades or modified leaf length;
- MGS series liquid Flow switch additional 6 "blade that can be used 100 – 150(mm) pipeline;
- Adjustable set point, the user may according to require to trim the flow value;
- Shell with fully closed structure, for electrical equipment are effective protection against dust and water vapor (which may be a small amount of dew);
- Electrical switches are the entire body, closed, for a small amount of dew will not have the risk of leakage;
- Large wiring space, easy for user wiring.

Application:

Typical applications of the freezer system, when the cooling water drying up, HLS can be effectively cut off the compressor current, in order to protect the freezer and the entire refrigeration system damage.

Specification:

		Switch action flow need (m ³ /h)													
Pipe diameter (mm)		25	32	40	50	65	80	100	125	150	200	100*	125*	150*	200*
Adjusting	Flow increase (red,blue closed)	0.95	1.32	1.70	3.11	4.09	6.24	14.8	28.4	43.2	85.2	8.4	12.9	16.8	46.6
	Flow decrease (red,yellow closed)	0.57	0.84	1.14	2.16	2.84	4.32	11.4	22.9	35.9	72.7	6.13	9.31	12.26	38.6
Max. Adjusting	Flow increase (red,blue closed)	2.0	3.02	4.36	6.6	7.84	12.0	29.1	55.6	85.2	172.6	13.4	26.8	32.7	94.26
	Flow decrease (red,yellow closed)	1.93	2.84	4.09	6.13	7.23	11.4	27.7	53.4	81.8	165.8	17.3	25.21	30.66	90.85

- The flow value for the selection of reference;
- With (*) is the values for the installation of all the four leaf values, without those for the three values;
- MGS flow switch installed in accordance with the flow rate of the overall pipeline using different kinds of leaves.

Electric loading	AC250V	15A	AC380V	10A
Max. Working pressure	10.34Bar			
Liquid temperature	0~120℃			
Environment temperature	0~60℃			
Bellows life	500000times			
Protecting standard	IP54			

Installation:

Pipe connection: 1" 11-1/2 NPT screw pipe connection

Direction of the arrow on the cylinder should be in line with the pipe flow;

Water flow switch should be installed in a horizontal pipeline, if must be installed in a vertical pipe, the liquid flow should be a bottom-up flow, absolutely not permit the installation by top-down flow of the vertical pipeline;

Flow switch in use is absolutely not permit to flow back to avoid the blade back into the fracture.

Attachment: Leaf Dressing Figure

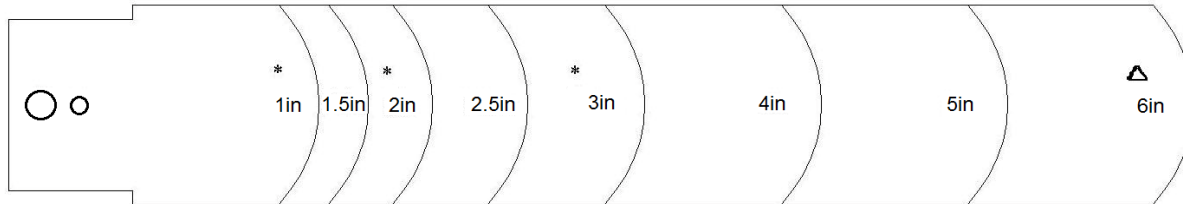

Notice :

With (*) leaves for the factory is installed;

With (Δ) for additional blades (not installed);

The remaining dimensions to correct use;

After the leaves trimmed to install, its top of the wall shall not have any friction with the wall and the bottom 5 - 10 mm gap.

Connection diagram :

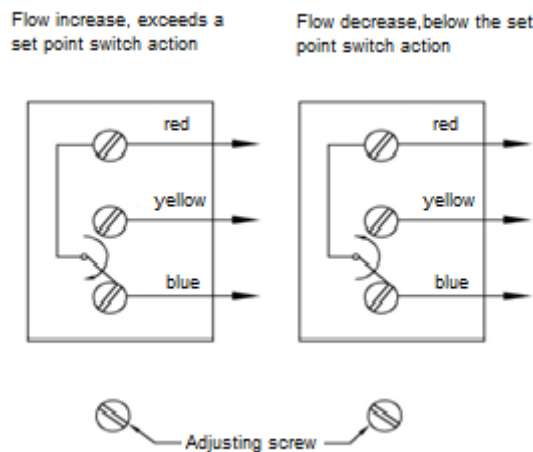

Typical installation diagram:

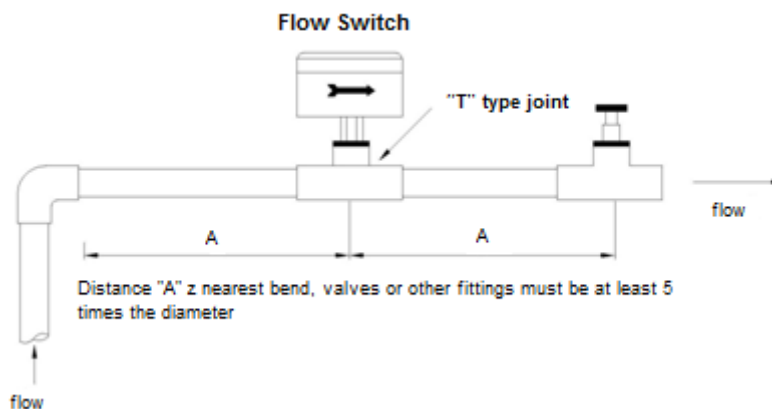

GPRO Valve Sdn Bhd

7, Lot 752 Jalan Subang 3, Taman
Perindustrian SG, Penaga 47610 Subang
Jaya, Selangor, MALAYSIA

Tel: +6 03 8023 6900
Whatsapp: +6 017 717 6900
Email: info@gprovalve.com.my
Website: www.gprovalve.com.my